

CONSTRUCTION NOTES:

1. REMOVE AND REPAIR RAMP
2. REMOVE AND REPLACE RAMP WITH 5' LONG RAMP
3. REMOVE AND REPLACE RAMP WITH DIRECTIONAL RAMP
4. REMOVE AND REPLACE RAMP WITH RAMP WITH HEADER CURB
5. REMOVE AND REPLACE RAMP WITH PARALLEL RAMP
6. REMOVE AND REPLACE RAMP WITH BLENDED TRANSITION
7. REPAIR AND REPLACE PCC SIDEWALK, 8 SY
8. EXPAND SIDEWALK WIDTH SO IT WILL ALIGN TO EXISTING DRIVEWAY, 17 SY
9. ADD POROUS FLEXIBLE PAVING, 12 SY
10. REPAIR AND REPLACE PCC SIDEWALK, 8 SY
11. REPAIR AND REPLACE PCC SIDEWALK, 9.6 SY
12. REPAIR AND REPLACE PCC SIDEWALK, 9.2 SY
13. REPAIR AND REPLACE PCC SIDEWALK, 8.8 SY
14. REPAIR AND REPLACE PCC SIDEWALK, 8.3 SY
15. ADD POROUS FLEXIBLE PAVING, 16 SY
16. REPAIR AND REPLACE PCC SIDEWALK, 7.3 SY
17. REPAIR AND REPLACE PCC SIDEWALK, 13 SY
18. PLACE ASPHALT PATCHING, 0.93 TONS
19. REPAIR AND REPLACE WALKWAY, 7.2 SY
20. REPAIR AND REPLACE PCC COPING, 1 CY
21. ADD PCC SIDEWALK, 30 SY
22. PLACE MULCH, 33 SY
23. TREE TO BE PLANTED BY UFA

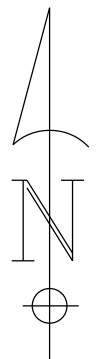

| | | |
|---------------|---------------------------------|----------------------------|
| LEGEND | EXISTING CONDITIONS | PCC SIDEWALK |
| | PROPOSED CONDITIONS | BRICK SIDEWALK |
| | EXISTING TRAFFIC SIGNAL CABINET | GRASS |
| | EXISTING PEDESTRIAN SIGNAL | DETECTABLE WARNING SURFACE |

The Temple Group, Inc.
 1120 Connecticut Avenue, NW
 Suite 310
 Washington, DC 20036
 Ph.: 202-822-6600
 Fax: 202-822-6603
 www.thetemplegroup.com

| No. | DESCRIPTION | NAME | DATE |
|-----------|-------------|------|------|
| REVISIONS | | | |

| | |
|--|----------------------|
| DISTRICT OF COLUMBIA DEPARTMENT OF TRANSPORTATION INFRASTRUCTURE PROJECT MANAGEMENT ADMINISTRATION | |
| CITY-WIDE AMERICANS WITH DISABILITIES ACT COMPLIANCE DCKA-2011-C-0059 | |
| BUNKER HILL RD. AT SHEPHERD ST./ 22ND ST., NE BUS STOP #1002291 | |
| PROJECT ENG. <u>AK</u> | DESIGN BY <u>AK</u> |
| CHECKED BY <u>AK</u> | DRAWN BY <u>VMD</u> |
| FILE _____ | DATE <u>02/19/14</u> |
| SHEET <u>01</u> OF <u>02</u> | DWG NO. _____ |

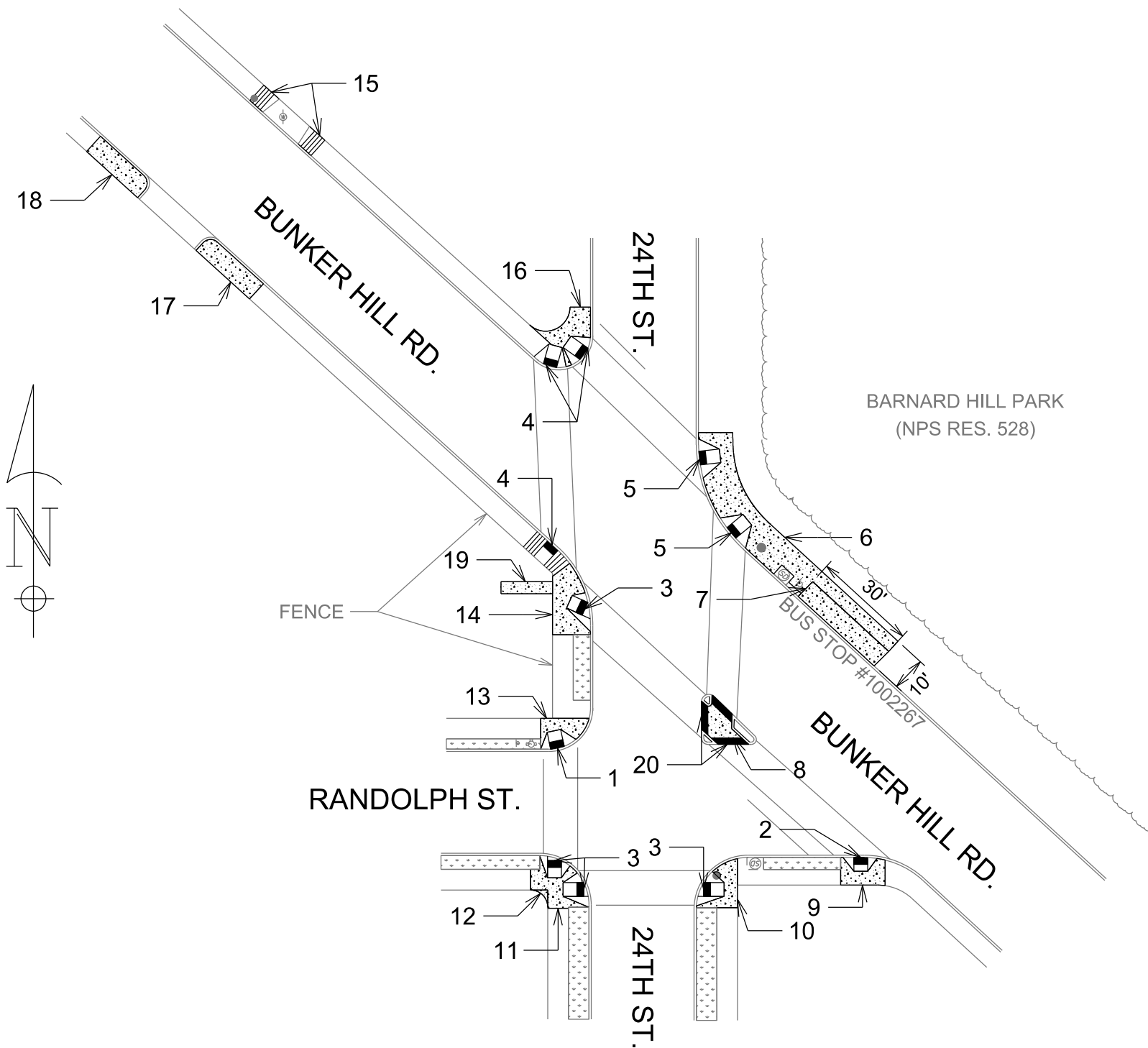

CONSTRUCTION NOTES:

1. REMOVE AND REPAIR RAMP WITH 5' LONG RAMP
2. REMOVE AND REPLACE RAMP WITH 4' LONG RAMP
3. REMOVE AND REPLACE RAMP WITH DIRECTIONAL RAMP
4. REMOVE AND REPLACE RAMP WITH PARALLEL
5. NEW RAMP
6. ADD PCC SIDEWALK, 61 SY
7. REPAIR AND REPLACE PCC SIDEWALK, 20 SY
8. CUT THROUGH MEDIAN 6' WIDE, 11.4 SY
9. REPAIR AND REPLACE PCC SIDEWALK, 8.2 SY
10. REPAIR AND REPLACE PCC SIDEWALK, 8.5 SY
11. REPAIR AND REPLACE PCC SIDEWALK, 10.3 SY
12. ADD PCC SIDEWALK, 0.6 SY
13. REPAIR AND REPLACE PCC SIDEWALK, 7 SY
14. REPAIR AND REPLACE PCC SIDEWALK, 15 SY
15. NEW PARALLEL RAMP, NO DETECTABLE WARNING SURFACE
16. ADD PCC SIDEWALK, 11 SY
17. REPAIR AND REPLACE PCC SIDEWALK, 14 SY
18. REPAIR AND REPLACE PCC SIDEWALK, 13 SY
19. REPAIR AND REPLACE PCC SIDEWALK, 6 SY
20. PLACE DETECTABLE WARNING SURFACE, 44 EA

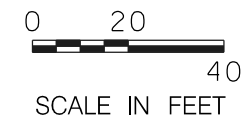

| | | |
|---------------|---------------------------------|----------------------------|
| LEGEND | EXISTING CONDITIONS | PCC SIDEWALK |
| | PROPOSED CONDITIONS | BRICK SIDEWALK |
| | EXISTING TRAFFIC SIGNAL CABINET | GRASS |
| | EXISTING PEDESTRIAN SIGNAL | DETECTABLE WARNING SURFACE |

The Temple Group, Inc.
 1120 Connecticut Avenue, NW
 Suite 310
 Washington, DC 20036
 Ph.: 202-822-6600
 Fax: 202-822-6603
 www.thetemplegroup.com

| No. | DESCRIPTION | NAME | DATE |
|-----------|-------------|------|------|
| REVISIONS | | | |
| | | | |
| | | | |
| | | | |
| | | | |

| | |
|--|----------------------|
| DISTRICT OF COLUMBIA DEPARTMENT OF TRANSPORTATION INFRASTRUCTURE PROJECT MANAGEMENT ADMINISTRATION | |
| CITY-WIDE AMERICANS WITH DISABILITIES ACT COMPLIANCE DCKA-2011-C-0059 | |
| BUNKER HILL RD. AT RANDOLPH ST./ 24TH ST., NE BUS STOP #1002267 | |
| PROJECT ENG. <u>AK</u> | DESIGN BY <u>AK</u> |
| CHECKED BY <u>AK</u> | DRAWN BY <u>VMD</u> |
| FILE _____ | DATE <u>02/19/14</u> |
| SHEET <u>02 OF 02</u> | DWG NO. _____ |