

PROJECT KEY:

SUBMISSION	DATE
FTG PERMIT	1/25/2013
FTG PERMIT REVISION	TBD
HORIZONTAL PERMIT	TBD

NO.	DATE	DESCRIPTION
1	1/8/2013	DRAFT

MAINE AVENUE MATERIAL PLAN PARCEL 2-5

DRAWING TITLE:

Author	SCALE
Drawn by	45680.05.J
Checked by	PROJECT NO.
Checked by	DATE: 1/25/2013
DATE:	L-130
DRAWING NO.	

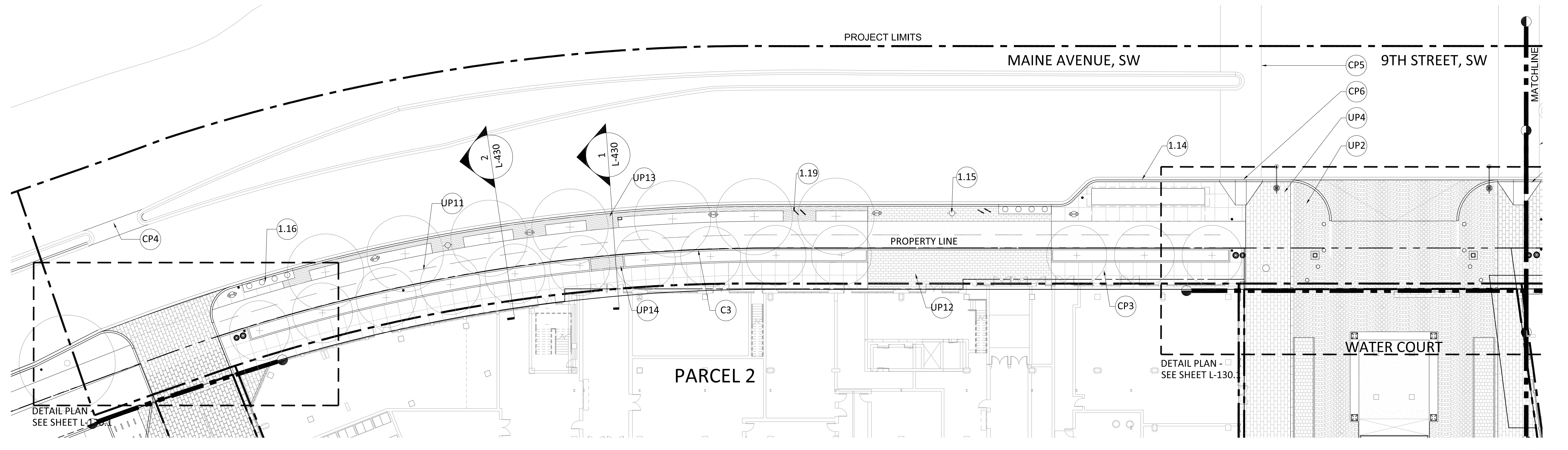

1 MAINE AVENUE - MATERIAL PLAN - PARCEL 2
L-130 SCALE: 1"=20'

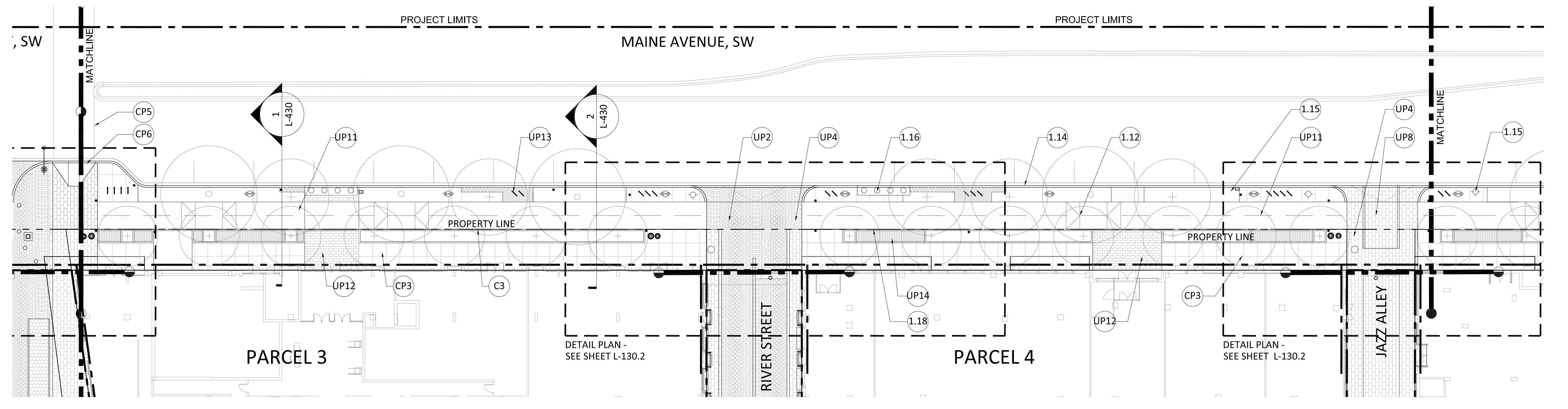

2 MAINE AVENUE - MATERIAL PLAN - PARCEL 3 & 4
L-130 SCALE: 1"=20'

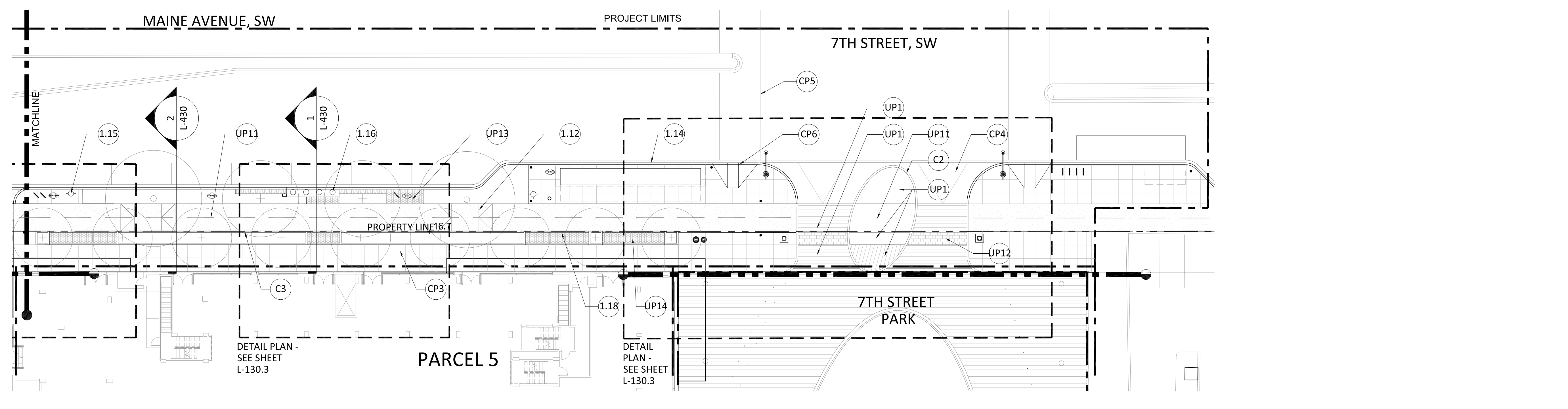

3 MAINE AVENUE - MATERIAL PLAN - PARCEL 5
L-130 SCALE: 1"=20'

CALLOUT SCHEDULE

- C2 GRANITE CURB
- C3 LID GRANITE CURB, SEE DETAIL 2, SHEET L-930
- CP3 DECORATIVE DARK CONCRETE - 5'X5' SCORING, SEE DETAIL 1, SHEET L-930
- CP4 CONCRETE PAVING IN MEDIAN, SEE CIVIL DWGS
- CP5 CROSSWALK - PIANO STRIPING, SEE CIVIL DWGS.
- CP6 ADA RAMP - CONCRETE, SEE CIVIL DWGS
- UP1 NARROW MODULAR PAVERS
- UP2 4"x4"x4" PORPHYRY PAVERS - FAN PATTERN
- UP4 6"x12"x4" PORPHYRY PAVERS
- UP8 BELGIAN BLOCK PAVERS
- UP11 FLEXI-PAVE BIKE LANE WITH STRIPING, SEE DETAIL 3, SHEET L-930
- UP12 12"x18" HANOVER PREST CONCRETE UNIT PAVERS(#M1493), RUNNING BOND, SEE DETAIL 22, SHEET L-930
- UP13 4"x4"x4" PERMEABLE CONCRETE UNIT PAVERS AT CURB WALK, SEE DETAIL 23, SHEET L-932
- UP14 PERMEABLE CONCRETE UNIT PAVERS RUNNING BOND PATTERN, SEE DETAIL 23, SHEET L-931.
- 1.12 RAMP OVER CRITICAL ROOT ZONE, SEE DETAIL 22, SHEET L-531
- 1.14 DC STANDARD CURB AND GUTTER, SEE CIVIL DWGS.
- 1.15 FIRE HYDRANT, SEE CIVIL DWGS.
- 1.16 STORM INLET, SEE CIVIL DWGS.
- 1.18 RAILING FOOTING AT PERMEABLE SIDEWALK PAVING, SEE DETAIL 34, SHEET L-930
- 1.19 CONTINUOUS SOIL TRENCH AT FURNISHING, DETAIL 34, SHEET L-931

MATERIAL NOTES

1. CONTRACTOR SHALL VERIFY ALL CONDITIONS IN THE FIELD AND REPORT ANY DISCREPANCIES TO THE LANDSCAPE ARCHITECT.
2. CONTRACTOR SHALL LOCATE AND VERIFY ALL EXISTING & ADJACENT UTILITIES, FACILITIES, AND STRUCTURES PRIOR TO CONSTRUCTION AND SHALL REPORT ANY CONFLICTS TO THE ARCHITECT AND CIVIL ENGINEER. CONTRACTOR SHALL TAKE SOLE RESPONSIBILITY FOR ANY INCURRED DAMAGE TO SAID FEATURES. CONTRACTOR SHALL RESTORE DISTURBED AREAS TO THEIR ORIGINAL CONDITIONS OR BETTER UNLESS OTHERWISE NOTED.
3. CONTRACTOR IS RESPONSIBLE FOR BECOMING FAMILIAR WITH ALL PLANS FOR UTILITY AND ARCHITECTURAL IMPROVEMENTS
4. REFER TO CIVIL DRAWINGS FOR DESIGN OF ROADWAY, CURB, AND ALL UTILITIES. SEE CIVIL DRAWINGS FOR ADJUSTMENTS AND REMOVAL OF ANY EXISTING UTILITIES OR STRUCTURES.
5. SOME CONSTRUCTION OCCURS OVER STRUCTURE. SEE ARCH. DRAWINGS.
6. THE CONTRACTOR SHALL BE RESPONSIBLE FOR COMPLETING WORK CALLED FOR ON THE DRAWINGS WHETHER OR NOT EACH WORK ELEMENT IS NOTED IN THE LEGENDS.
7. ALL ADA RAMP AND CROSSWALK LOCATIONS TO BE APPROVED IN THE FIELD BY DDOT OFFICIAL. ALL ADA RAMP AND CROSSWALKS SHALL CONFORM TO THE LATEST ADAAG CRITERIA.
8. MATERIALS SUBJECT TO MODIFICATION OR SUBSTITUTION FOR CONSISTENCY WITH FINAL ZONING ORDER.