

PROJECT NARRATIVE

THIS PROJECT CALLS FOR AN ARCHAEOLOGICAL INVESTIGATION OF THREE NON-CONTIGUOUS AREAS WITHIN FORT WARD PARK, OWNED BY THE CITY OF ALEXANDRIA AT 4301 BRADDOCK ROAD. IN ADDITION TO CIVIL WAR FORTIFICATIONS, WHICH ARE CURRENTLY THE FOCUS OF HISTORICAL INTERPRETATION IN THE PARK, THERE IS POTENTIAL FOR THE PROPERTY TO CONTAIN BURIED REMNANTS OF OTHER UNION ARMY ACTIVITIES, TRACES OF NATIVE AMERICAN OCCUPATION, AND EVIDENCE OF AN AFRICAN AMERICAN NEIGHBORHOOD KNOWN AS "THE FORT" THAT THRIVED ON THE SITE FROM AT LEAST THE 1870S OR 1880S UNTIL THE PARK WAS CREATED IN THE EARLY 1960S. THE AFRICAN AMERICAN COMMUNITY INCLUDED HOMES, OTHER BUILDINGS SUCH AS A SCHOOLHOUSE/CHURCH, AND CEMETERIES. THE ARCHAEOLOGICAL INVESTIGATION WILL LOCATE, IDENTIFY, AND EVALUATE THESE POTENTIAL BURIED RESOURCES. THE WORK WILL FOCUS ON IDENTIFYING LOCATIONS OF BURIAL SITES AND LIMITS OF CEMETERIES AND WILL ALSO EXPLORE THE HISTORICALLY KNOWN LOCATIONS OF AN AFRICAN AMERICAN SCHOOLHOUSE/CHURCH AND THE EARLIEST KNOWN AFRICAN AMERICAN HOME SITE ON THE PROPERTY. THE ARCHAEOLOGICAL WORK SHALL INCLUDE METAL DETECTION, SHOVEL TESTS, HAND-EXCAVATED ARCHAEOLOGICAL UNITS, AND BOTH HAND AND MECHANICAL SCRAPING OFF OF THE TOPSOIL.

THE AREAS OF ARCHAEOLOGICAL WORK INCLUDE THE FOLLOWING: 1.8363 ACRES THAT FORM THE FORMER MAINTENANCE YARD OF THE DEPARTMENT OF RECREATION, PARKS, AND CULTURAL ACTIVITIES ALONG WITH A SMALL AREA, KNOWN AS THE OLD GRAVEYARD, OUTSIDE OF THE MAINTENANCE YARD; 0.9080 ACRES TO THE EAST OF THE ENTRANCE ROAD NORTH OF THE OAKLAND BAPTIST CHURCH CEMETERY; AND 0.1378 ACRES OF A POSSIBLE FAMILY CEMETERY WEST OF THE FORTIFICATION.

PROJECT NOTES:

1. TREE PRESERVATION: THERE WILL BE NO MECHANICAL EXCAVATION WITHIN 6 FEET OF ANY TREE. EFFORTS WILL BE MADE TO KEEP ALL MECHANICAL EXCAVATION A PRESCRIBED DISTANCE AWAY FROM INDIVIDUAL TREES, ACCORDING TO THE FOLLOWING FORMULA: A DISTANCE IN FEET EQUAL TO THE DIAMETER OF THE TREE TRUNK IN INCHES. TREE PROTECTION WILL BE APPROVED IN-FIELD BY THE CITY ARBORIST PRIOR TO COMMENCEMENT OF GROUND DISTURBING ACTIVITIES.
2. EXACT LOCATIONS OF ALL EXCAVATION UNITS (INCLUDING TRENCHES, SCRAPED AREAS, AND HAND-DUG UNITS) WITHIN THE LIMITS OF DISTURBANCE MAY CHANGE AS A RESULT OF FINDINGS DURING THE COURSE OF THE ARCHAEOLOGICAL WORK.
3. AS EXCAVATION UNITS (TRENCHES, SCRAPED AREAS, OR HAND-DUG UNITS) ARE COMPLETED, THEY WILL BE BACKFILLED, RETURNED AS CLOSELY AS POSSIBLE TO THE PRE-EXCAVATION GRADE, SEEDED, AND COVERED WITH STRAW.
4. THE LIMITS OF DISTURBANCE MAY BE MODIFIED IN THE FIELD TO PROVIDE ACCESS TO SOME WORK AREAS.
5. ALL WORK ASSOCIATED WITH THIS PROJECT SHALL BE WITHIN THE LIMITS OF DISTURBANCE. VEHICLES, CONSTRUCTION STAGING, OR STORAGE OF MATERIALS NOT WITHIN THE LIMITS OF DISTURBANCE SHALL BE APPROVED BY RPCA AND THE CITY ARCHEOLOGIST.

GENERAL NOTES

1. VERTICAL DATUM: NAVD '88
2. HORIZONTAL DATUM: NAD '83
3. BENCH MARKS:

BM#1: ELEVATION = 276.87
DESCRIPTION = TOP OF GRATE INLET

BM#2: ELEVATION = 281.36
DESCRIPTION = TRAVERSE POINT.

4. THE CITY SURVEYORS ARE TO VERIFY FIELD CONDITIONS PRIOR TO AND DURING CONSTRUCTION AND NOTIFY T&ES AT 746-4035 IMMEDIATELY OF ANY DISCREPANCIES BETWEEN ACTUAL FIELD CONDITIONS AND APPROVED PLAN.
5. EXISTING UNDERGROUND UTILITIES ARE KNOWN TO EXIST IN AND AROUND THE PROPOSED WORK AREAS. EXISTING UNDERGROUND UTILITY INFORMATION IS TAKEN FROM AVAILABLE RECORDS. THE CONTRACTOR IS RESPONSIBLE TO CONTACT "MISS UTILITY" UTILITY SERVICE PROTECTION CENTER AT 1-800-552-7001 REGARDING THE LOCATION OF THESE UNDERGROUND UTILITIES, AND FOR VERIFYING THE EXACT LOCATION OF ALL UTILITIES PRIOR TO CONSTRUCTION. THE CONTRACTOR IS RESPONSIBLE FOR ANY DAMAGES THAT MAY OCCUR DUE TO HIS FAILURE TO LOCATE AND PROTECT THESE UNDERGROUND FACILITIES.
6. THE CONTRACTOR IS RESPONSIBLE FOR ANY DAMAGES TO EXISTING ROADS AND UTILITIES THAT OCCUR AS A RESULT OF HIS CONSTRUCTION PROJECT WITHIN OR CONTIGUOUS TO EXISTING CITY OR STATE RIGHT-OF-WAYS.
7. THE CITY OF ALEXANDRIA DEPARTMENT OF T&ES DIVISION OF ENVIRONMENTAL QUALITY MUST BE NOTIFIED IF UNUSUAL OR UNANTICIPATED CONTAMINATION IS ENCOUNTERED ON THE SITE. SOIL CONTAMINATION AND RELEASES TO THE ENVIRONMENT WILL BE HANDLED IN ACCORDANCE WITH FEDERAL, STATE AND CITY REGULATIONS.
8. ALL CONSTRUCTION ACTIVITIES SHALL COMPLY WITH THE ALEXANDRIA NOISE CONTROL CODE, TITLE 11, CHAPTER 5, WHICH PERMITS CONSTRUCTION ACTIVITY TO OCCUR BETWEEN THE FOLLOWING HOURS: MONDAY THROUGH FRIDAY 7AM TO 6PM AND SATURDAY FROM 9AM TO 6PM. NO CONSTRUCTION ACTIVITY IS PERMITTED ON SUNDAY. ANY DEVIATION FROM THESE WORK HOURS SHALL REQUIRE CITY APPROVAL.
9. THE CONTRACTOR SHALL BE RESPONSIBLE FOR NOTIFYING THE OWNER OF ANY CHANGES OR CONDITIONS ATTACHED TO PERMITS OBTAINED FROM ANY AUTHORITY ISSUING PERMITS.
10. THE CONTRACTOR SHALL VISIT THE SITE AND SHALL VERIFY EXISTING CONDITIONS PRIOR TO STARTING CONSTRUCTION.
11. ALL AREAS, ON OR OFF-SITE, WHICH ARE DISTURBED BY THIS CONSTRUCTION AND WHICH ARE NOT PAVED OR BUILT UPON, SHALL BE ADEQUATELY STABILIZED TO CONTROL EROSION AND SEDIMENTATION. THE MINIMUM ACCEPTABLE STABILIZATION SHALL CONSIST OF PERMANENT GRASS, SEED MIXTURE TO BE AS RECOMMENDED BY THE CITY AGENT. ALL SLOPES 3:1 AND GREATER SHALL BE SODDED AND PEGGED OR OTHERWISE STABILIZED IN A MANNER APPROVED BY THE CITY OF ALEXANDRIA.
12. DAMAGE TO ANY EXISTING ENTRANCES, CURB AND GUTTER, PAVEMENT OR OTHER EXISTING STRUCTURES NOT PROPOSED TO BE DISTURBED WITH THIS PROJECT, WILL BE THE RESPONSIBILITY OF THE CONTRACTOR AND MUST BE REPAIRED TO THE SATISFACTION OF THE CITY OF ALEXANDRIA, VIRGINIA DEPARTMENT OF TRANSPORTATION AND ANY ADJOINING OWNERS THAT MAY BE AFFECTED.
13. THE DESIGN, CONSTRUCTION, FIELD PRACTICES AND METHODS SHALL CONFORM TO THE REQUIREMENTS SET FORTH BY THE CITY OF ALEXANDRIA AND ITS CURRENT ZONING ORDINANCE AND CONSTRUCTION STANDARDS MANUAL. FAILURE TO COMPLY WITH THE CODE, APPLICABLE MANUALS, PROVISIONS OF THE CONSTRUCTION AND ESCROW AGREEMENTS OR THE PERMITS SHALL BE DEEMED A VIOLATION.
14. THE APPROVAL OF THESE PLANS SHALL IN NO WAY RELIEVE THE CONTRACTOR OR HIS AGENT OF ANY LEGAL RESPONSIBILITIES WHICH MAY BE REQUIRED BY THE CODE OF VIRGINIA OR ANY ORDINANCE ENACTED BY THE CITY OF ALEXANDRIA.
15. THE STAKEOUT SHALL BE PERFORMED BY THE CITY'S SURVEY DEPARTMENT.
17. THERE ARE MAPPED RESOURCE PROTECTION AREAS (RPA) ON THIS PROPERTY.
18. ALL EROSION CONTROLS SHALL CONFORM TO THE VIRGINIA EROSION AND SEDIMENT CONTROL HANDBOOK (THIRD EDITION 1992) AND MUST BE SUBMITTED AND APPROVED BY T&ES.
19. ALL CONSTRUCTION ACTIVITIES SHALL CONFORM WITH LATEST EDITION OF OSHA REGULATIONS AND GUIDELINES.
20. NO EXISTING IMPROVEMENTS ARE TO BE REMOVED UNLESS NOTED AS SUCH.

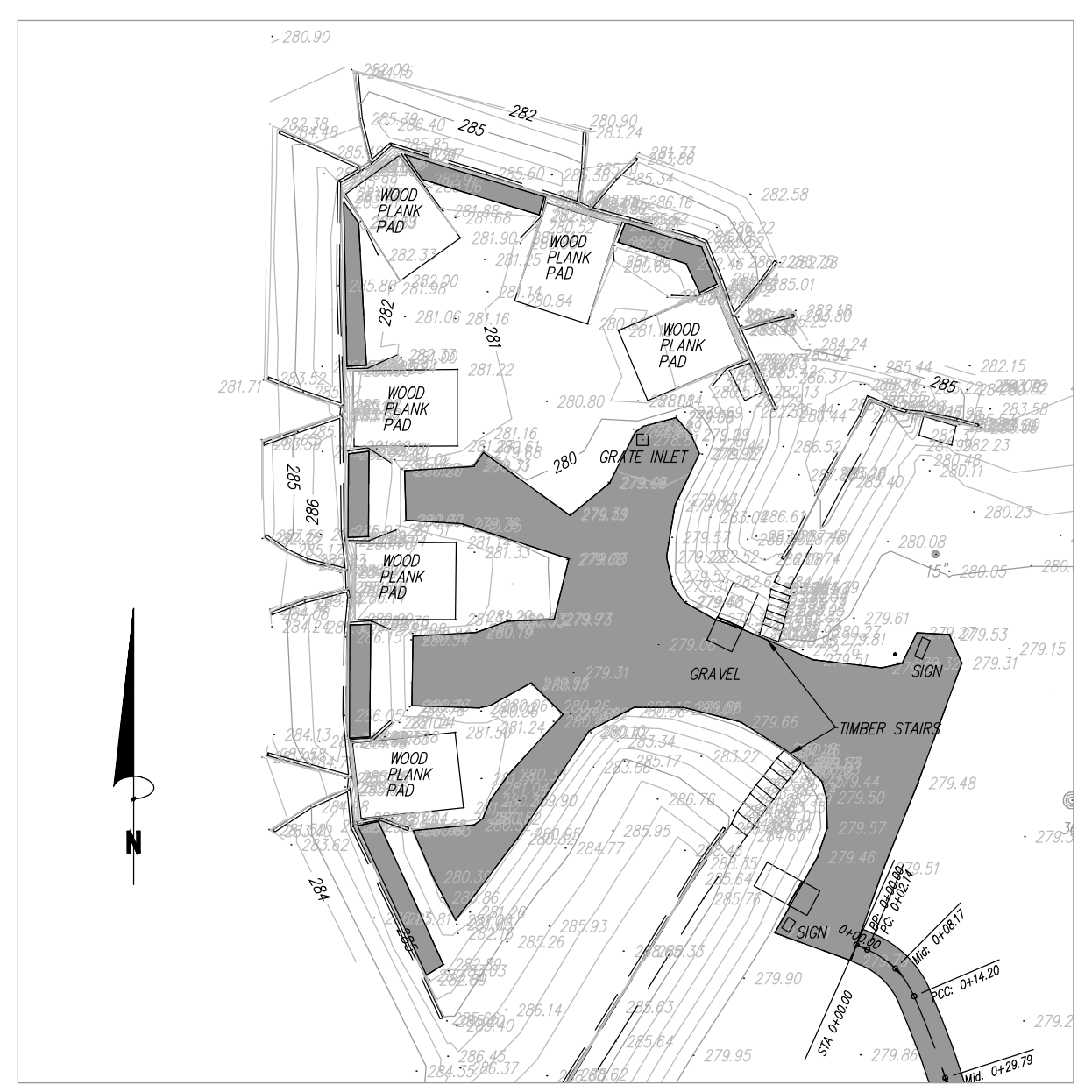

APPROVED DATE _____

DIRECTOR OF TRANSPORTATION
AND ENVIRONMENTAL SERVICES

FORT WARD PARK/BASTION WALKWAY PROJECT

CITY OF ALEXANDRIA, VIRGINIA
Transportation & Environmental Services
P. O. Box 178
Alexandria, Virginia 22313



DESIGN ENGINEER: RF	Date: 05/12	REVISIONS	COMMENTS
CADD ENGINEER: MS	Date: 05/12	INITIALS	
DIVISION CHIEF:	Date:		
CITY ENGINEER:	Date:		
DIRECTOR T&ES:	Date:		

Scale: 1" = 30' Project No. _____