

- CONSTRUCTION NOTES:**
1. REMOVE AND REPLACE PCC RAMP, TYP.
  2. REMOVE AND REPLACE PCC SIDEWALK
  3. REMOVE AND REPLACE MEDIAN ISLAND (601991)
  4. ADJUST MANHOLE
  5. REPAIR PCC SIDEWALK
  6. ADD NEW HIGH VISIBILITY PSVRMNT MARKINGS
  7. INSTALL DETECTABLE WARNING SURFACE 6'X2'

<b>LEGEND</b>		PCC SIDEWALK
		BRICK SIDEWALK
		GRASS
		EXISTING CONDITIONS
		PROPOSED CONDITIONS
		DETECTABLE WARNING SURFACE
		FENCE

**The Temple Group, Inc.**  
 1120 Connecticut Avenue, NW  
 Suite 310  
 Washington, DC 20036  
 Ph.: 202-822-6600  
 Fax: 202-822-6603  
 www.thetemplegroup.com

No.	DESCRIPTION	NAME	DATE

DISTRICT OF COLUMBIA DEPARTMENT OF TRANSPORTATION INFRASTRUCTURE PROJECT MANAGEMENT ADMINISTRATION	
<b>CITY-WIDE AMERICANS WITH DISABILITIES ACT COMPLIANCE</b> DCKA-2011-C-0059	
RHODE ISLAND AVE FROM 7TH ST. TO NEW JERSEY AVE, NW BUS STOP #1001539	
PROJECT ENG. <u>AK</u> DESIGN BY <u>SA</u> CHECKED BY <u>AK</u> DRAWN BY <u>SA</u>	FILE _____ DATE _____ SHEET <b>01 OF 03</b> DWG NO. _____

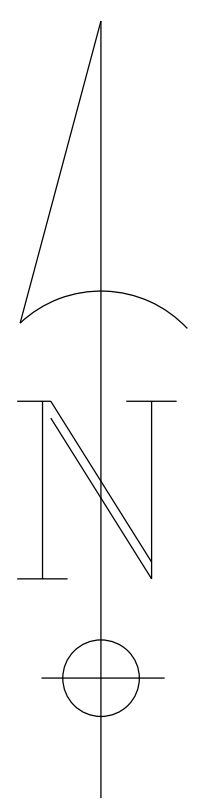

**CONSTRUCTION NOTES:**

1. REMOVE AND REPLACE PCC RAMP, TYP.
2. REMOVE AND REPLACE PCC RAMP, 5' LONG
3. REMOVE AND REPLACE SIDEWALK
4. ADD POROUS FLEXIBLE PAVING, 18'X6'
5. REMOVE AND REPLACE SIDEWALK, 18'X6'
6. REMOVE AND RELOCATE FENCE (OFFSET TBD BY THE ENGINEER ON SITE)
7. REMOVE AND REPLACE MEDIAN ISLAND, NO PAVERS (601991)
8. ADJUST WATER METER
9. ADD POROUS FLEXIBLE PAVING, 30'X9'
10. REMOVE AND REPLACE PCC RAMP, 4' LONG

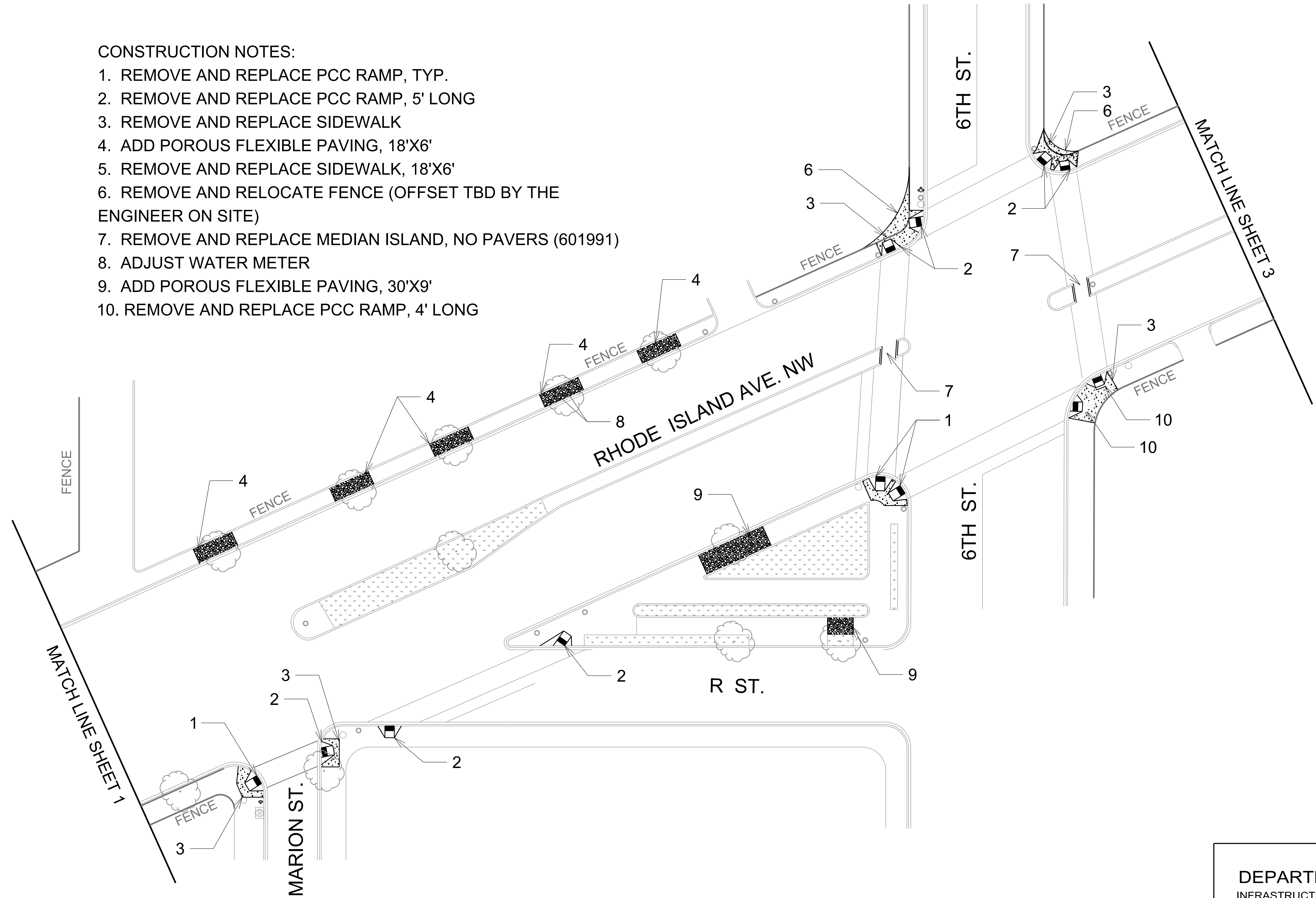

<b>LEGEND</b>		PCC SIDEWALK
		BRICK SIDEWALK
		GRASS
		EXISTING CONDITIONS
		PROPOSED CONDITIONS
		DETECTABLE WARNING SURFACE

**The Temple Group, Inc.**  
 1120 Connecticut Avenue, NW  
 Suite 310  
 Washington, DC 20036  
 Ph.: 202-822-6600  
 Fax: 202-822-6603  
 www.thetemplegroup.com

No.	DESCRIPTION	NAME	DATE
REVISIONS			

DISTRICT OF COLUMBIA DEPARTMENT OF TRANSPORTATION INFRASTRUCTURE PROJECT MANAGEMENT ADMINISTRATION	
<b>CITY-WIDE AMERICANS WITH          DISABILITIES ACT COMPLIANCE</b> DCKA-2011-C-0059	
RHODE ISLAND AVE FROM 7TH ST. TO NEW JERSEY AVE, NW	PROJECT ENG. <u>AK</u> DESIGN BY <u>SA</u> CHECKED BY <u>AK</u> DRAWN BY <u>SA</u>
FILE _____ DATE _____ SHEET <b>02 OF 03</b>	DWG NO. _____

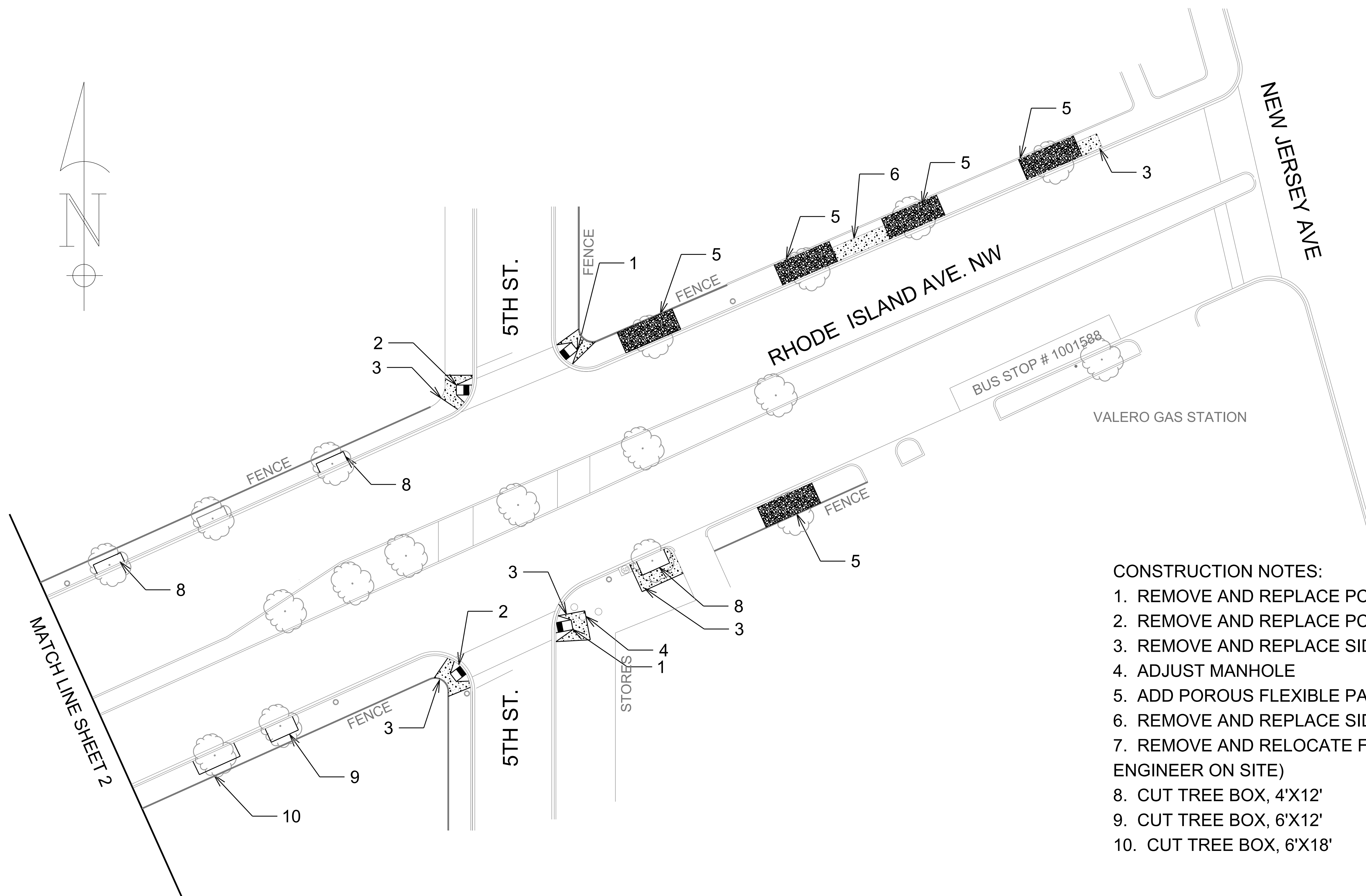
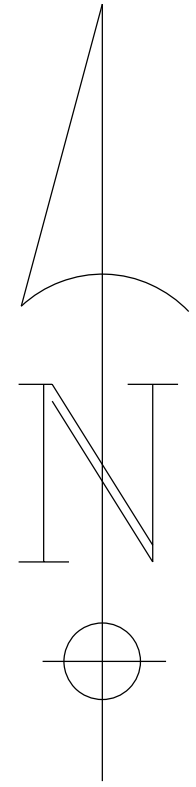

**CONSTRUCTION NOTES:**

1. REMOVE AND REPLACE PCC RAMP, TYP.
2. REMOVE AND REPLACE PCC RAMP, 5' LONG
3. REMOVE AND REPLACE SIDEWALK
4. ADJUST MANHOLE
5. ADD POROUS FLEXIBLE PAVING, 24'X9'
6. REMOVE AND REPLACE SIDEWALK, 24'X6'
7. REMOVE AND RELOCATE FENCE (OFFSET TBD BY THE ENGINEER ON SITE)
8. CUT TREE BOX, 4'X12'
9. CUT TREE BOX, 6'X12'
10. CUT TREE BOX, 6'X18'

<b>LEGEND</b>		PCC SIDEWALK
		BRICK SIDEWALK
		GRASS
		EXISTING CONDITIONS
		PROPOSED CONDITIONS
		DETECTABLE WARNING SURFACE

**The Temple Group, Inc.**  
 1120 Connecticut Avenue, NW  
 Suite 310  
 Washington, DC 20036  
 Ph.: 202-822-6600  
 Fax: 202-822-6603  
 www.thetemplegroup.com

No.	DESCRIPTION	NAME	DATE
REVISIONS			

DISTRICT OF COLUMBIA DEPARTMENT OF TRANSPORTATION INFRASTRUCTURE PROJECT MANAGEMENT ADMINISTRATION	
<b>CITY-WIDE AMERICANS WITH DISABILITIES ACT COMPLIANCE</b> DCKA-2011-C-0059	
RHODE ISLAND AVE FROM 7TH ST. TO NEW JERSEY AVE, NW BUS STOP #1001588	
PROJECT ENG. <u>AK</u> DESIGN BY <u>SA</u> CHECKED BY <u>AK</u> DRAWN BY <u>SA</u>	FILE _____ DATE _____ SHEET <b>03</b> OF _____ DWG NO. _____