

9 CONCRETE PAVEMENT AT WOOD FIBER SURFACING
L6.1 SECTION 1/2"=1'-0"

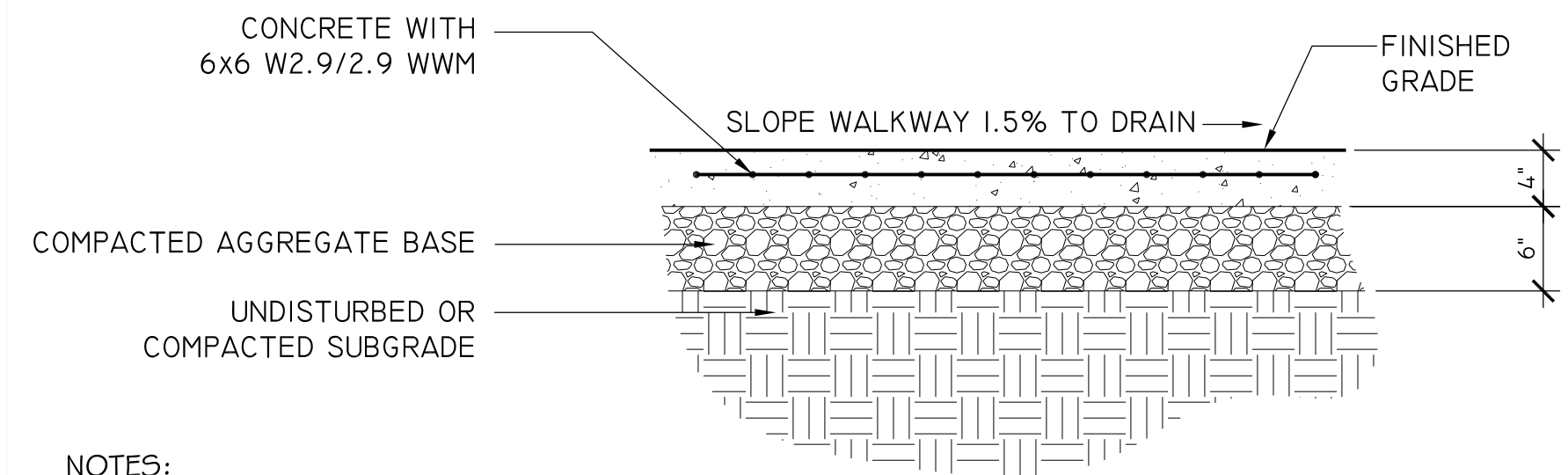

10 CONCRETE PAVEMENT (4" THICKNESS)
L6.1 SECTION 1"=1'-0" Revised 02751.1

- NOTES:
1. PROVIDE EXPANSION AND CONTROL JOINTS AS SHOWN ON THE PLANS, OR EXPANSION JOINTS EVERY 20' O.C. AND CONTROL JOINTS EVERY 5' O.C. IF NOT SHOWN.
 2. ALL EXPANSION JOINTS SHALL BE FINISHED WITH SEALANT. COLOR TO MATCH COLOR OF CONCRETE PAVEMENT.
 3. FINISH IN ACCORDANCE WITH VDOT 404.07, SIDEWALK FINISH, WITH CLEAR CURING COMPOUND.
 4. DISTURBED LAWN AREAS ADJACENT TO CONCRETE PAVEMENT SHALL BE BACKFILLED AND SEEDDED AS DESCRIBED IN SPECIFICATIONS.
 5. REFER TO CONCRETE DETAILS, THIS SHEET FOR ADDITIONAL CONDITIONS AND REQUIREMENTS, AS NEEDED.

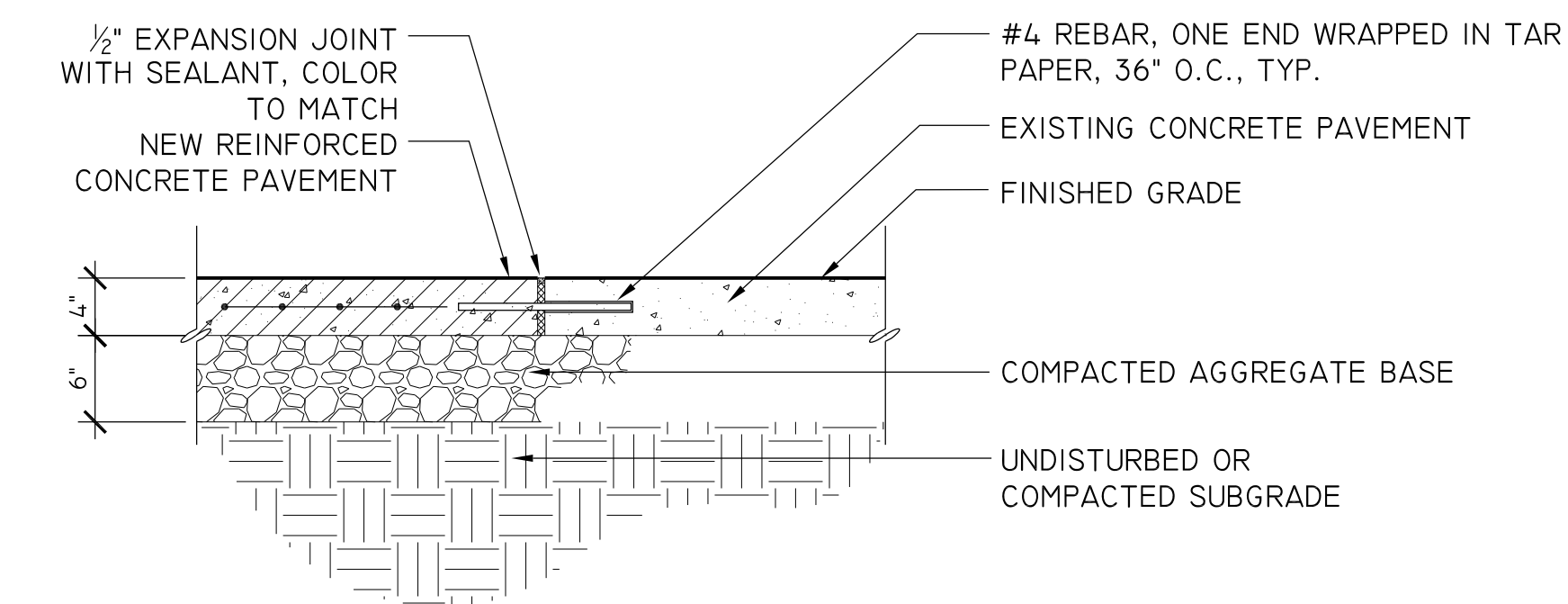

11 REINFORCED CONCRETE PAVEMENT (4" THICKNESS)
L6.1 SECTION 1"=1'-0"

- NOTES:
1. PROVIDE EXPANSION JOINTS EVERY 20' O.C. (UNLESS OTHERWISE SHOWN) AND AROUND HARD OBJECTS SUCH AS HYDRANTS, MANHOLE COVERS, EXISTING PAVEMENTS, ETC.
 2. PROVIDE CONTROL JOINTS EVERY 5' O.C. OR AS SHOWN ON THE PLANS.
 3. EXPANSION JOINTS SHALL BE SEALED WITH SEALANT. COLOR TO MATCH COLOR OF CONCRETE.
 4. FINISH IN ACCORDANCE WITH VDOT 404.07, SIDEWALK FINISH.
 5. DISTURBED LAWN AREAS ADJACENT TO CONCRETE PAVEMENT SHALL BE BACKFILLED AND SEEDDED AS DESCRIBED IN SPECIFICATIONS.

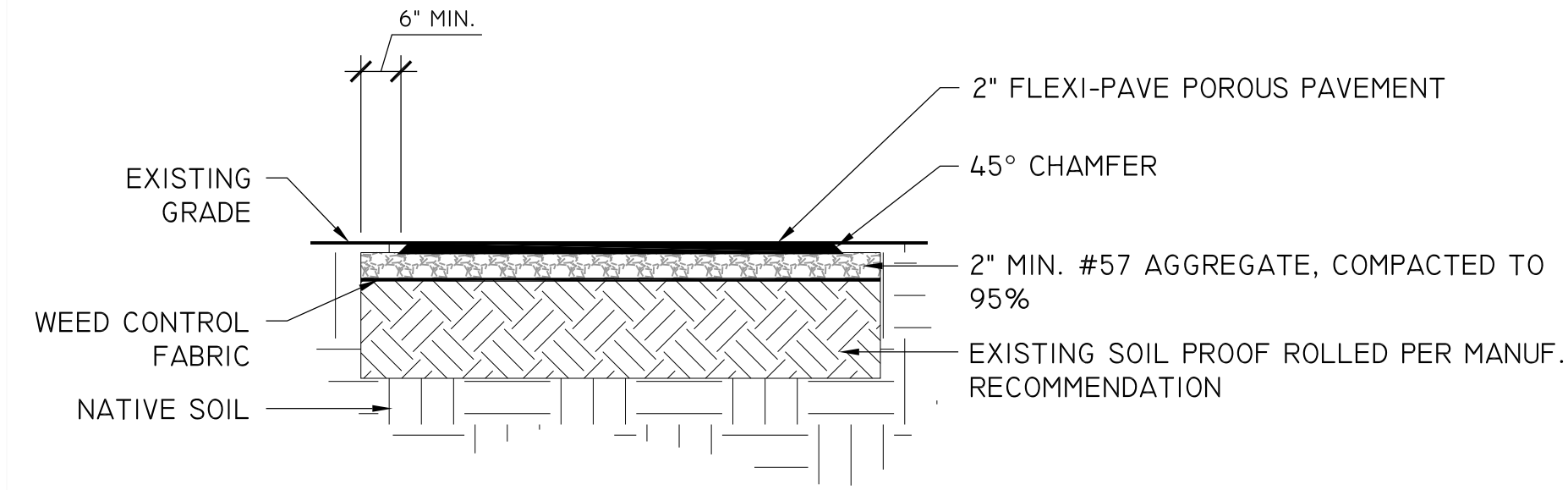

12 POROUS PAVEMENT PATH
L6.1 SECTION 1"=1'-0"

- NOTES:
1. PAVEMENT SHALL BE INSTALLED PER MANUFACTURER'S RECOMMENDATION. CONTRACTOR SHALL PROVIDE SHOP DRAWINGS TO PROJECT OFFICER FOR APPROVAL, PRIOR TO INSTALLATION.

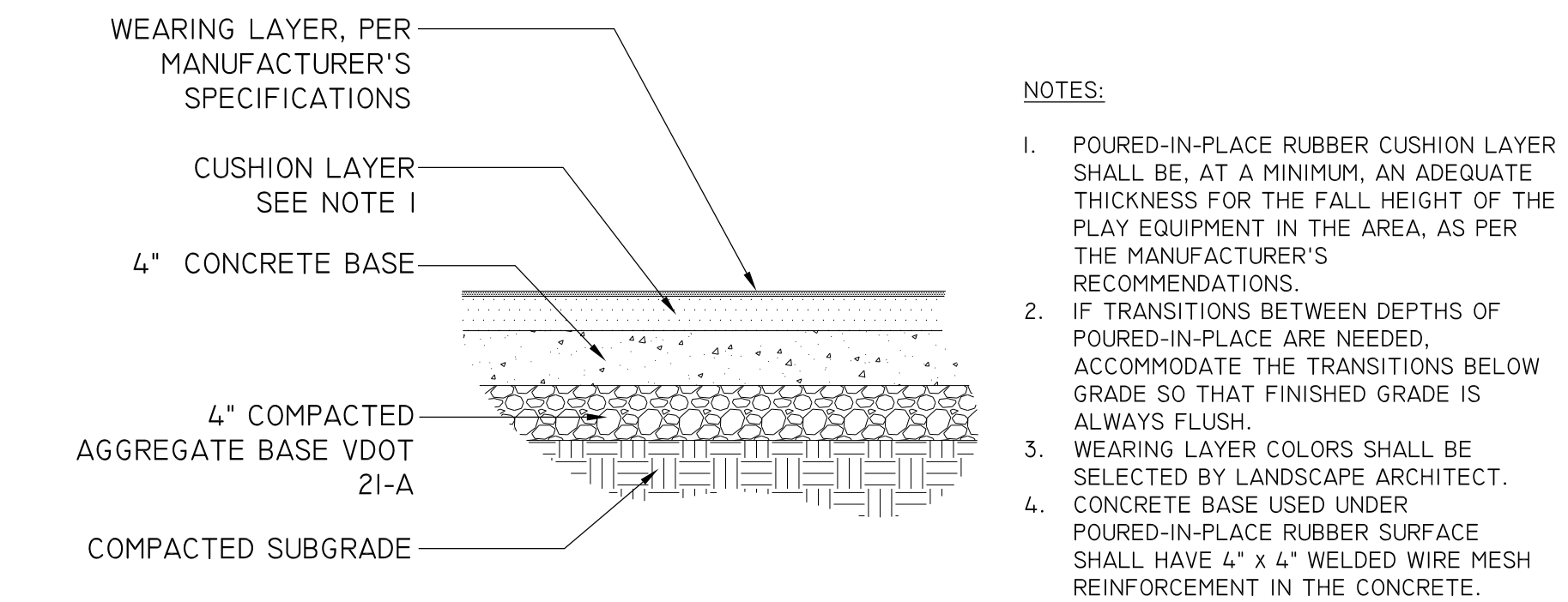

14 POURED IN PLACE PLAY SURFACE
L6.1 SECTION 1"=1'-0" 02791.5

- NOTES:
1. POURED-IN-PLACE RUBBER CUSHION LAYER SHALL BE, AT A MINIMUM, AN ADEQUATE THICKNESS FOR THE FALL HEIGHT OF THE PLAY EQUIPMENT IN THE AREA, AS PER THE MANUFACTURER'S RECOMMENDATIONS.
 2. IF TRANSITIONS BETWEEN DEPTHS OF POURED-IN-PLACE ARE NEEDED, ACCOMMODATE THE TRANSITIONS BELOW GRADE SO THAT FINISHED GRADE IS ALWAYS FLUSH.
 3. WEARING LAYER COLORS SHALL BE SELECTED BY LANDSCAPE ARCHITECT. CONCRETE BASE USED UNDER POURED-IN-PLACE RUBBER SURFACE SHALL HAVE 4" x 4" WELDED WIRE MESH REINFORCEMENT IN THE CONCRETE.

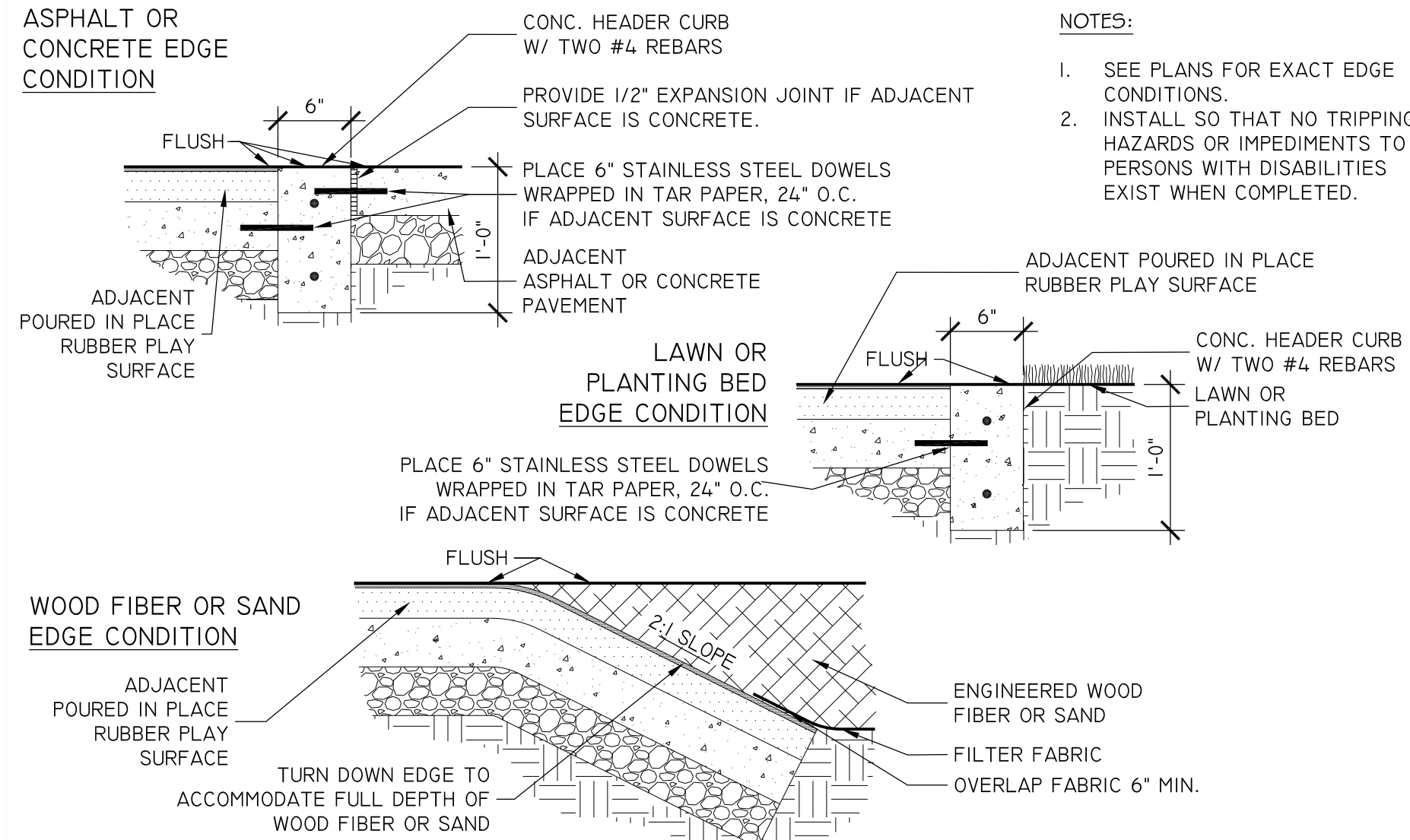

15 POURED IN PLACE EDGE CONDITION
L6.1 SECTION 1"=1'-0" 02791.8

- NOTES:
1. SEE PLANS FOR EXACT EDGE CONDITIONS.
 2. INSTALL SO THAT NO TRIPPING HAZARDS OR IMPEDIMENTS TO PERSONS WITH DISABILITIES EXIST WHEN COMPLETED.

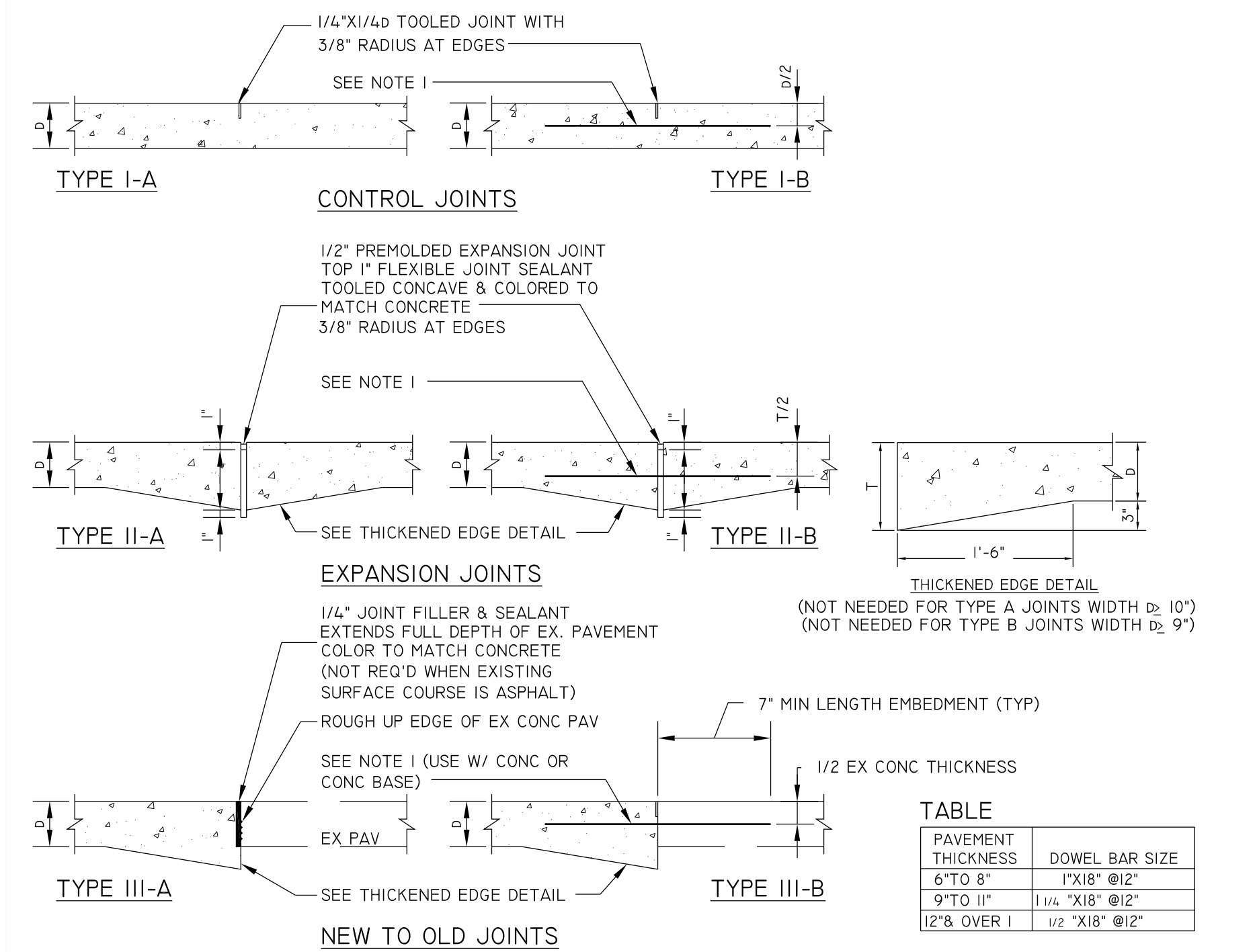

- NOTES:
1. WHERE REQUIRED AT TRANSVERSE JOINTS, DOWEL BARS SHALL BE SIZED AS SHOWN IN THE TABLE. SMOOTH ROUND GRADE 60 OR BETTER WITH ENDS WRAPPED IN TAR PAPER.
 2. TRANSVERSE JOINT SPACE SHALL NOT EXCEED SPACING INDICATED IN PLANS. THE AREA OF THE PAVEMENT PANEL SHALL NOT EXCEED 225 SQUARE FEET.
 3. JOINT OFFSETS AT RADIUS POINTS SHOULD BE AT LEAST 1'-6" LONG.
 4. JOINT INTERSECTION ANGLES OF LESS THAN 60 DEGREES SHALL BE USED.
 5. WHEN A JOINT IS CLOSER THAN 1'-0" TO A CASTING, THEN A MINOR ADJUSTMENT IN THE JOINT LOCATION SHOULD BE MADE BY SKEWING OR SHIFTING THE JOINT ALIGNMENT TO MEET THE CASTING AT 90° OR NORMAL TO THE CASTING.
 6. DOWEL BARS SHALL NOT BE PLACED WITHIN 1'-0" OF THE EDGE OF PAVEMENT OR A PARALLEL JOINT.

PAVEMENT THICKNESS	DOWEL BAR SIZE
6" TO 8"	1"X18" @12"
9" TO 11"	1 1/4"X18" @12"
12" & OVER	1 1/2"X18" @12"

13 CONCRETE PAVING JOINT DETAILS
L6.1 ELEVATION NOT TO SCALE

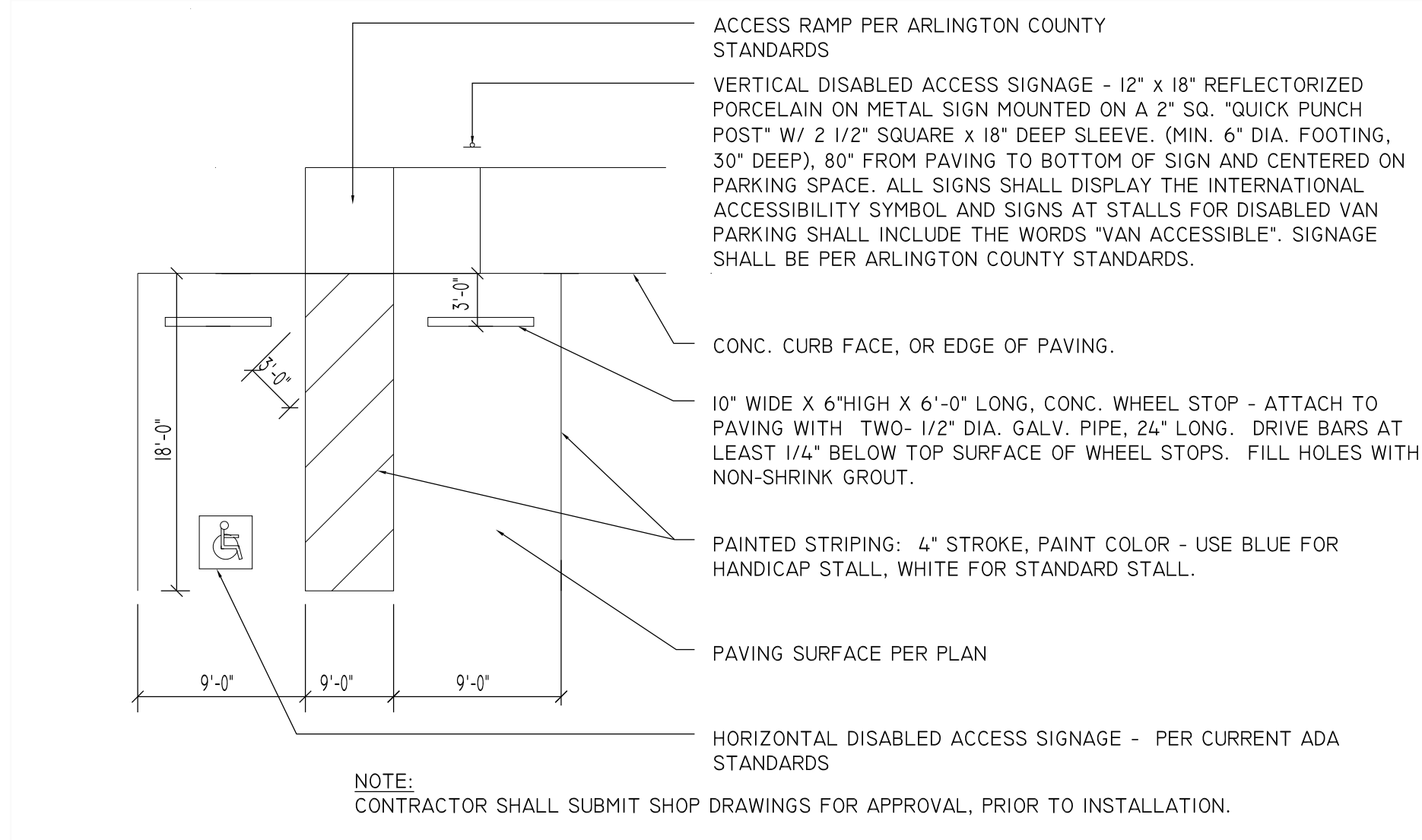

16 VAN ACCESSIBLE PARKING / STRIPING
L6.1 PLAN N.T.S.

- NOTES:
1. ACCESS RAMP PER ARLINGTON COUNTY STANDARDS
 2. VERTICAL DISABLED ACCESS SIGNAGE - 12" x 18" REFLECTORIZED PORCELAIN ON METAL SIGN MOUNTED ON A 2" SQ. "QUICK PUNCH POST" W/ 2 1/2" SQUARE x 18" DEEP SLEEVE. (MIN. 6" DIA. FOOTING, 30" DEEP), 80" FROM PAVING TO BOTTOM OF SIGN AND CENTERED ON PARKING SPACE. ALL SIGNS SHALL DISPLAY THE INTERNATIONAL ACCESSIBILITY SYMBOL AND SIGNS AT STALLS FOR DISABLED VAN PARKING SHALL INCLUDE THE WORDS "VAN ACCESSIBLE". SIGNAGE SHALL BE PER ARLINGTON COUNTY STANDARDS.
 3. CONCRETE CURB FACE, OR EDGE OF PAVING.
 4. 10" WIDE X 6" HIGH X 6'-0" LONG, CONC. WHEEL STOP - ATTACH TO PAVING WITH TWO-1/2" DIA. GALV. PIPE, 24" LONG. DRIVE BARS AT LEAST 1/4" BELOW TOP SURFACE OF WHEEL STOPS. FILL HOLES WITH NON-SHRINK GROUT.
 5. PAINTED STRIPING: 4" STROKE, PAINT COLOR - USE BLUE FOR HANDICAP STALL, WHITE FOR STANDARD STALL.
 6. PAVING SURFACE PER PLAN
 7. HORIZONTAL DISABLED ACCESS SIGNAGE - PER CURRENT ADA STANDARDS
- NOTE: CONTRACTOR SHALL SUBMIT SHOP DRAWINGS FOR APPROVAL, PRIOR TO INSTALLATION.



DEPARTMENT OF PARKS AND RECREATION

Park Development Division
2100 Clarendon Boulevard, Suite 414
Arlington, VA 22201
Phone: 703.228.3323
Fax: 703.228.3328

IFB #732-13

Project Name and Location

Woodstock Park
Playground
Reconstruction

2049 N. Woodstock Street
Arlington, VA

Sheet Title
Site Details

Approvals Date

Department Director

Park Development Division Chief

Design Unit Supervisor 7.11.13

Revisions Date

Designed: DESIGN
Drawn: DRAW
Checked: CHECK

Filename: Details.dwg
Plotted: Jun 27, 2013

Scale: SCALE
Date: DATE

Seal

Sheet 16 of 21

L6.1