

NO.	REVISION	DATE

EWING COLE
1025 Connecticut Avenue, NW
Suite 800
Washington, DC 20008-5405
Tel: 202-462-1500 Fax: 202-696-6600

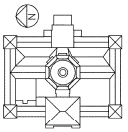

PROPERTY OF THE
UNITED STATES GOVERNMENT
FOR OFFICIAL USE ONLY
Do not remove this notice.
Properly destroy documents
when no longer needed.



RECOMMENDED FOR APPROVAL

DIRECTOR OF DESIGN SERVICES

DIRECTOR OF PLANNING & PROJECT MANAGEMENT

STEPHAN T. AYERS, AIA, LEED AP
ARCHITECT OF THE CAPITOL

PROJECT TITLE
**THOMAS JEFFERSON
BUILDING**
PROJECT FILE
**NORTHWEST COURTYARD
RENOVATION**

DRAWING TITLE
**REFERENCE &
LAYOUT PLAN**

SCALE
1" = 4'-0"

DATE
02/29/10

DESIGNED BY
L101

L101

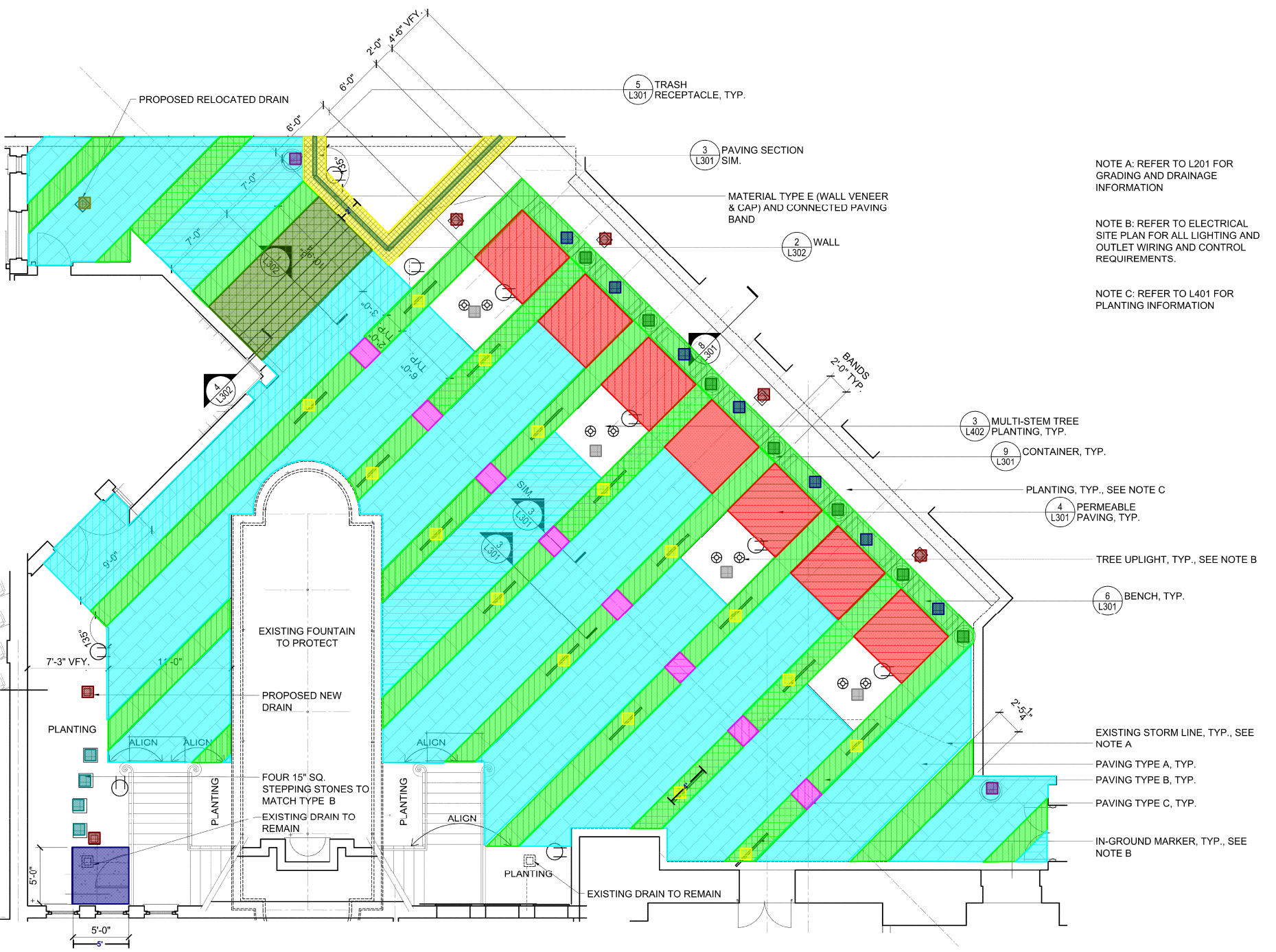

NOTE A: REFER TO L201 FOR
GRADING AND DRAINAGE
INFORMATION

NOTE B: REFER TO ELECTRICAL
SITE PLAN FOR ALL LIGHTING AND
OUTLET WIRING AND CONTROL
REQUIREMENTS.

NOTE C: REFER TO L401 FOR
PLANTING INFORMATION

PLANTING, TYP., SEE NOTE C

TREE UPLIGHT, TYP., SEE NOTE B

EXISTING STORM LINE, TYP., SEE
NOTE A

PAVING TYPE A, TYP.

PAVING TYPE B, TYP.

PAVING TYPE C, TYP.

IN-GROUND MARKER, TYP., SEE
NOTE B

1 REFERENCE & LAYOUT PLAN
1" = 4'-0"

