

**SQUARE 3712**

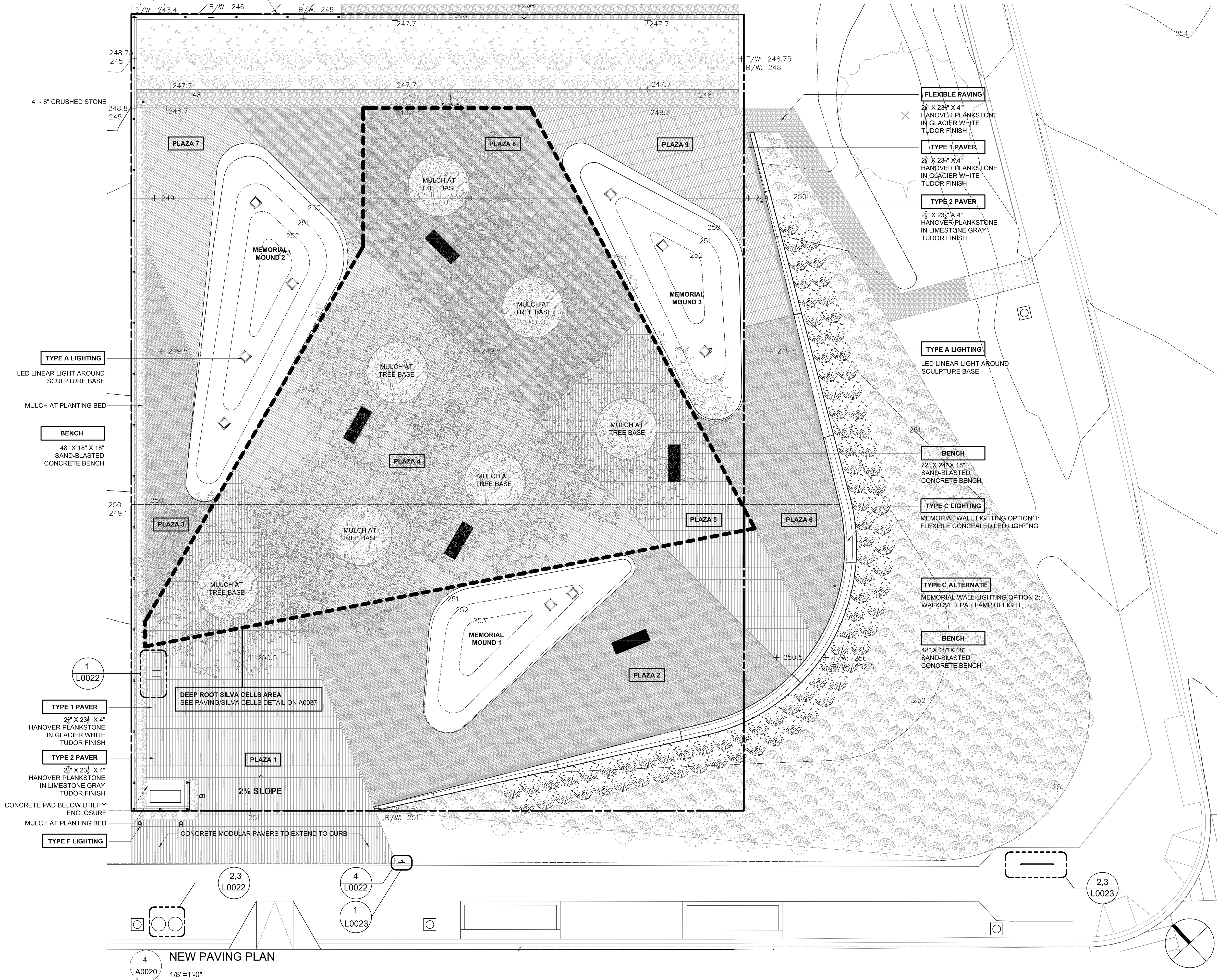

PAVING SCHEDULE							
TYPE	PAVER SIZE	PAVER TYPE	MANUFACTURER	FINISH	COLOR	SPACING	SETTING
1	2 1/2" X 23 1/2" X 4"	PLANKSTONE	HANOVER	TUDOR	GLACIER WHITE	1/8"	SAND SET
2	2 1/2" X 23 1/2" X 4"	PLANKSTONE	HANOVER	TUDOR	LIMESTONE GRAY	1/8"	SAND SET
2	N/A	FLEXI-PAVE	KBI	N/A	MOSSY SLATE	N/A	COMPACTED STONE

- NOTE:**
- HANDLE AND STORE PRODUCT ACCORDING TO MANUFACTURER RECOMMENDATIONS. FOLLOW GENERALLY ACCEPTED MASONRY PRACTICE. SIDES OF PAVERS SHALL BE PARALLEL, WITH COURSES STRAIGHT. SPACES BETWEEN THE PAVERS SHALL NOT BE LESS THAN 1/8". PAVERS ARE TO BE LAID WITH EVEN BEARING AND SUPPORTED EQUALLY.
  - PAVERS SHOULD BE INSTALLED MAINTAINING A MAXIMUM 1/8" JOINT AND MUST BE CONTAINED BY THE USE OF AN EDGE RESTRAINT.
  - INSTALL FLEXIBLE PAVEMENT PER MANUFACTURER'S SPECIFICATIONS.
  - PROVIDE BEVELED EDGING, PER MANUFACTURER'S SPECIFICATIONS WHEN FLEXI-PAVE ABUTS GRASS AREAS.

BENCH SCHEDULE							
TYPE	BENCH SIZE	NAME	MANUFACTURER	FINISH	SEALER	MATERIAL	SETTING
1	48" X 18" X 18"	TF5117	WAUSAUTILE	H15 WHITE ACID WASH CONCRETE	POLISHED TOP SURFACE	CONCRETE	ANCHORED W/ BOLTS

LIGHT FIXTURE SCHEDULE							
BASE SELECTIONS							
TYPE	MANUFACTURER	DESCRIPTION	COLOR TEMP	LAMPS	POWER	MOUNTING	REMARKS
A	GRUPO MCI	GROUNDLINER 250	NW 4100K	LED	3.84 W	SCULPTURE	DIMMABLE
C	GRUPO MCI	SMART LED FLEX	NW 3500K	LED	9.6 W/M	RECESSED @ MEMORIAL WALL BASE	DIMMABLE
F	DESIGNPLAN	WALKOVER PAR LAMP UPLIGHT	3000K	METAL HALIDE	120V/39W	IN-GROUND	8 LENS OPTION 1: ASYMMETRIC LENS W/ CERAMIC COATINGS ON VERTICAL SURFACE. 2 FLAT SLIGHTLY FROSTED
ALTERNATE SELECTIONS							
A	ELECTRIX	L280W LUMILINE	3500K	LED	7.6 W/FT	SCULPTURE	DIMMABLE
C	DESIGNPLAN	WALKOVER PAR LAMP UPLIGHT	3000K	METAL HALIDE	120V/39W	IN-GROUND	8 LENS OPTION 1: ASYMMETRIC LENS W/ CERAMIC COATINGS ON VERTICAL SURFACE. 2 FLAT SLIGHTLY FROSTED
F	DESIGNPLAN	WALKOVER PAR LAMP UPLIGHT	3000K	METAL HALIDE	120V/39W	IN-GROUND	8 LENS OPTION 1: ASYMMETRIC LENS W/ CERAMIC COATINGS ON VERTICAL SURFACE. 2 FLAT SLIGHTLY FROSTED

**NEW PAVING PLAN**  
1/8"=1'-0"

<p>DC COMMISSION ON THE ARTS &amp; HUMANITIES</p>	<p>THE DEPARTMENT OF GENERAL SERVICES</p>		<p>TEAM</p> <p>ARCHITECTURE HUNT LAUD STUDIO, LLC 1504 SWANN STREET NW WASHINGTON, DC 20009 202.986.1182</p> <p>LANDSCAPE ARCHITECTURE CARVALHO + GOOD, PLLC 1025 CONNECTICUT AVENUE, NW SUITE 1000 WASHINGTON, DC 20006 202.957.8720</p>	<p>GEOTECHNICAL DMY CAPITOL, LLC 1818 NEW YORK AVENUE, NE SUITE 214K WASHINGTON, DC 20002 202.636.1180</p> <p>CIVIL VIVA CAPITOL, LLC 4910 MASSACHUSETTS AVENUE, NW SUITE 214 WASHINGTON, DC 20016 202.244.4140</p>	<p>STRUCTURAL HOLBERT APPLE ASSOCIATES, INC. 3423 OLNEY-LAYTONSVILLE ROAD SUITE 6 OLNEY, MD 20832 301.570.1460</p> <p>MECHANICAL, ELECTRICAL, PLUMBING ENGENIUM GROUP 1001 CONNECTICUT AVENUE SUITE 1128 WASHINGTON, DC 20036 202.505.3646</p>	<p>PROJECT NAME &amp; ADDRESS</p> <p><b>METRO MEMORIAL PARK</b> 0 SOUTH DAKOTA AVE. NE, WASHINGTON, DC 20011</p>	<p>PROJECT OWNER &amp; ADDRESS</p> <p>DEPARTMENT OF GENERAL SERVICES 2000 14TH ST NW, 8TH FLOOR WASHINGTON, DC 20009</p> <p>ALPHONSO FUELLING 202-727-6087</p> <p>JENNIFER.BATTLE @MCKISSACKDC.COM</p>	<p>PROJECT PHASE</p> <p><b>CONSTRUCTION SET FOR PERMITTING</b></p>	<p>SUBMISSIONS</p> <table border="1"> <tr><td>SCHEMATIC DESIGN</td><td>5-23-14</td></tr> <tr><td>DESIGN DEVELOPMENT</td><td>6-23-14</td></tr> <tr><td>PERMIT PROGRESS SET</td><td>7-02-14</td></tr> <tr><td>PERMIT PROGRESS SET</td><td>9-11-14</td></tr> <tr><td>RFI #5</td><td>10-7-14</td></tr> <tr><td>PERMIT SET</td><td>12-03-14</td></tr> </table>	SCHEMATIC DESIGN	5-23-14	DESIGN DEVELOPMENT	6-23-14	PERMIT PROGRESS SET	7-02-14	PERMIT PROGRESS SET	9-11-14	RFI #5	10-7-14	PERMIT SET	12-03-14	<p>REVISIONS</p> <table border="1"> <tr><td> </td><td> </td></tr> <tr><td> </td><td> </td></tr> <tr><td> </td><td> </td></tr> <tr><td> </td><td> </td></tr> <tr><td> </td><td> </td></tr> <tr><td> </td><td> </td></tr> </table>													<p>DESIGNED BY</p> <p>JH/LL/ML/AW</p> <p>DRAWN BY</p> <p>ML/AW</p> <p>CHECKED BY</p> <p>JH</p> <p>DATE</p> <p>12-03-14</p>	<p>STAMP</p>	<p>SHEET</p> <p><b>A0020</b></p>
			SCHEMATIC DESIGN	5-23-14																																	
DESIGN DEVELOPMENT	6-23-14																																				
PERMIT PROGRESS SET	7-02-14																																				
PERMIT PROGRESS SET	9-11-14																																				
RFI #5	10-7-14																																				
PERMIT SET	12-03-14																																				