

CLINIC ENTRANCE GRADING

NOTE: GRADING OVER 4" IN 12" WATER MAIN SHALL NOT INCREASE COVER BY EXCESS OF 20'. OTHERWISE, THE MAIN WILL NEED RELOCATION TO REDUCE COVER.

- NOTES:
1. SEE SHEET C02 FOR ADDITIONAL GRADING.
 2. SEE SHEET C02 FOR HCAR RAMP GRADING.
 3. SEE GRAD DETAIL SHEET 04A FOR PAVING PAIRTY-4 FOR UNBUILT UNDERGARMENTS.

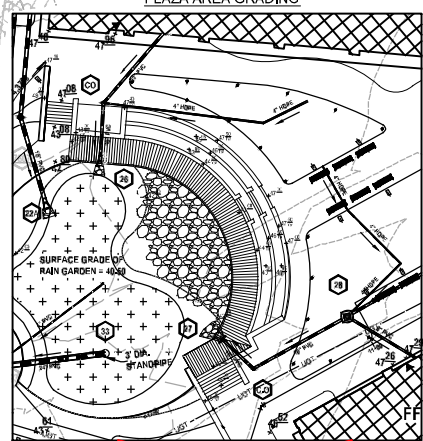

1:80

NO.	DATE	REVISION
1	10/20/15	20% PERMIT SET
2	12/15/15	GRADING REVISION
3	03/02/16	ADD LANDSCAPE
4	05/18/16	ADD 2015
5	07/20/16	2016
6	08/01/16	2016

100% WORKING DRAWINGS

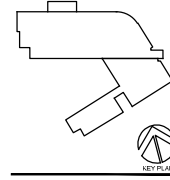

Perkins Eastman
221 GARDEN CITY PLAZA
FARFAX, VA 22033
TEL: 703.686.0000

Owner: **George Mason University**
1400 University Drive, Suite 300
Fairfax, VA 22033
TEL: 703.686.0000

Architect: **Perkins Eastman**
221 Garden City Plaza, Suite 300
Fairfax, VA 22033
TEL: 703.686.0000

Engineer: **McClain & Associates, Inc.**
837 West Avenue #125
Falls Church, VA 22046
TEL: 703.655.0051

Interior Designer: **McClain & Associates**
1410 S. Eggleston Street
Chattanooga, TN 37421
TEL: 412.266.4500

100% Model: **The Skanska Group, Inc.**
700 Woodrow Drive, Suite 200
Falls Church, VA 22046
TEL: 703.272.9100

Field Service: **Hopkins Foodservice Specialists, Inc.**
7900 Montross Boulevard, Suite 100
Chesapeake, VA 23060
TEL: 813.280.0000

PROJECT TITLE:
ACADEMIC VII / RESEARCH III
4408 PATRIOT CIRCLE,
FAIRFAX, VA 22030
Project Code: 247-17999-000

PROJECT NO: 49130.00
DRAWING TITLE:
GRADING AND DRAINAGE PLAN

SCALE:
C201

100% WORKING DRAWINGS
1 MAY 2015